

Installation Instructions

LOW LEVEL / CLOSE COUPLED-SYPHON

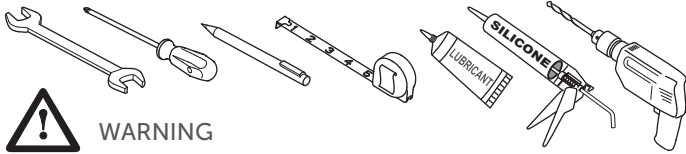

WARNING

Do not use or drop any chlorine or chemical related components into the cistern or closet bowl.

Use of such products will:

- (a) Result in damage to tank components, and may cause flood and property damage.
- (b) Void warranty.

Important Notes

There may be a flow restrictor pre-installed in the inlet valve, which should be removed for installations with very low supply pressure. Please see the inlet valve instructions supplied separately. Take care to avoid cross-threading. Do not over-tighten back-nuts. Care should be taken when drilling walls and floors to avoid any sunken wires or pipes. Servicing valve: The Water Regulations have a requirement to fit a servicing valve adjacent to the cistern (not supplied). Do not over-tighten nuts or cistern / bowl may crack.

Cistern assembly

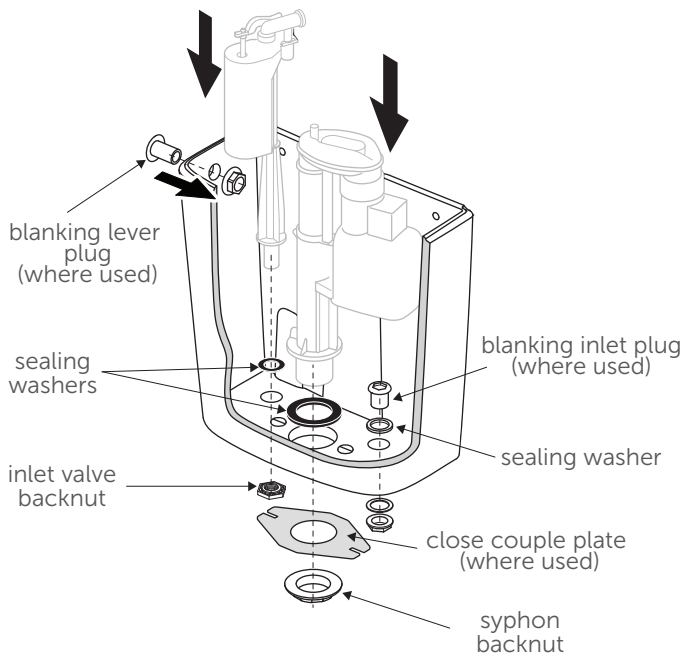
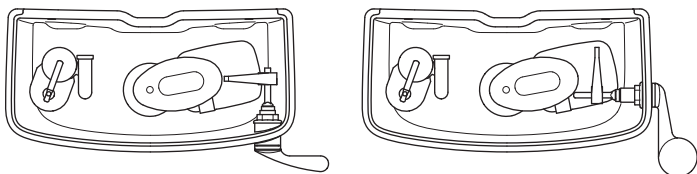

Figure 1

Diagrams are pictorial only and outlines of items shown may not represent the actual pieces supplied.

Where required, fit inlet valve and syphon into cistern, please refer to separate instruction where provided before assembling.

Ensure rubber sealing washers are positioned inside of cistern, (Fig. 1), and moving parts do not foul the cistern wall or other fittings.

Parts Required (not supplied)

Brass Screws and Fixing Plugs to secure the cistern and closet bowl.

Operating Water Pressure For Inlet Valve

0.2 Bar - 8.0 Bar

An operating lever is supplied to suit the closet suite. Follow appropriate instructions below. With all operating lever assemblies, ensure that the lever moves freely.

Front Operating Lever (Fig. 1.1)

Insert the lever with threaded sleeve and plated shaped washer, into the hole in the cistern. Place the internal shaped washer onto the threaded sleeve, fit the backnut but do not fully tighten. Connect the operating lifter arm to the 'C' link. Slide the lifter arm onto the spindle. Observe the resting lever angle is correct. Adjust the position of the arm so it is clear from the top of the syphon when the lever assembly is operated. Tighten the lifter arm set screw. Adjust the shaped washer for correct fit and tighten the backnut.

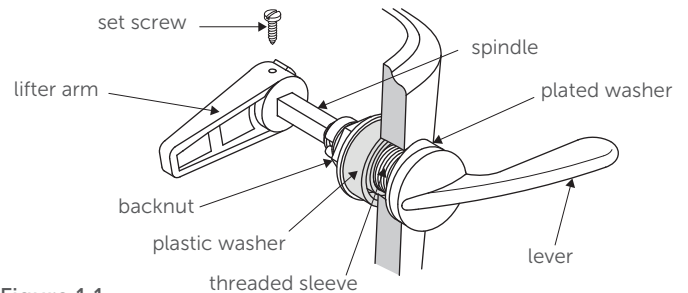

Figure 1.1

Side Operating Lever (Fig. 1.2)

Insert the lever with threaded sleeve into the hole in the cistern. Fit plastic washer and the backnut but do not fully tighten. Connect the operating lifter arm to the 'C' link. Slide the lifter arm onto the spindle. Observe the resting lever angle is correct. Adjust the position of the arm so it is clear from the top of the syphon when the lever assembly is operated. Tighten the lifter arm set screw. Tighten the backnut.

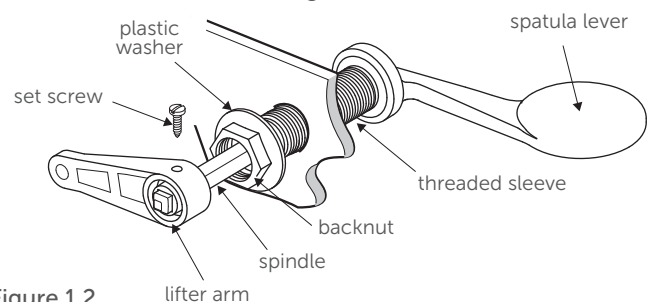

Figure 1.2

Low level

INSTALLATION

Diagrams shown are pictorial only and outlines of items shown may not represent the actual pieces supplied.

Fit inlet valve and syphon into cistern, refer to separate instruction where provided. Ensure rubber sealing washers are positioned inside of cistern, (Fig. 1), and moving parts do not foul the cistern wall or other fittings.

Position and fix cistern support brackets to the wall, (Fig. 2). Brackets are to be located within the recess at the back of the cistern, (bracket fixings not supplied).

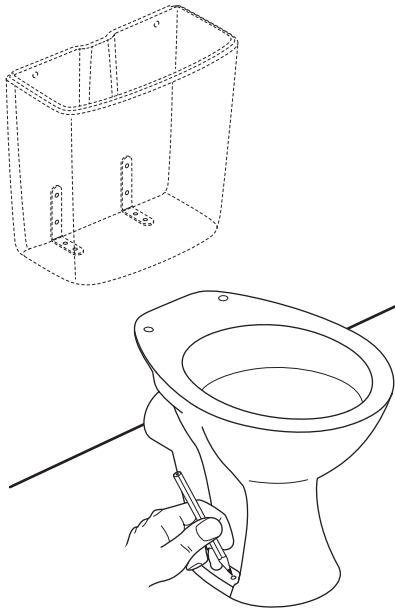

Figure 2

Position closet bowl and mark closet screw holes positions on floor. Remove closet bowl and drill floor to suit fixings, (not supplied) (Fig. 2).

Locate cistern on cistern support brackets (Fig. 3) and mark screw hole positions on wall. Remove cistern and drill and plug wall. Reposition cistern and screw to wall with No. 12 RH wood-screws (not supplied).

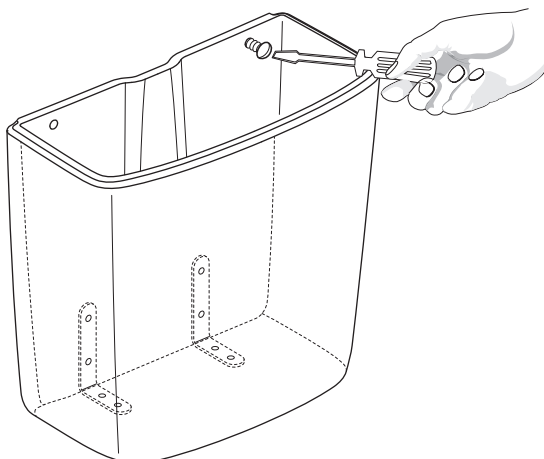

Figure 3

Insert flush pipe connector (Fig. 4) into closet bowl inlet, if unit is supplied with flow restrictor, then this is placed into pan inlet before flush pipe connector.

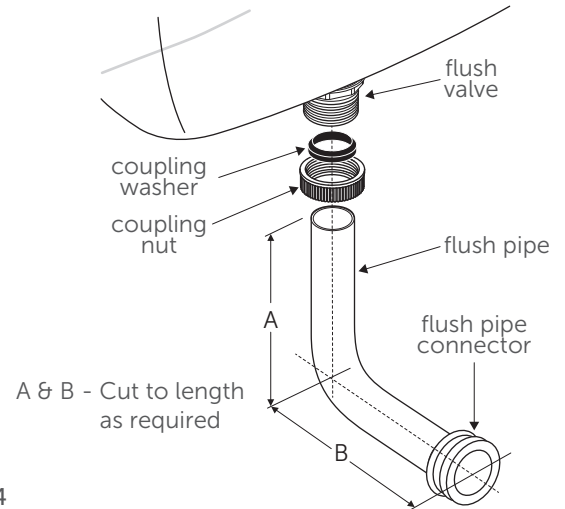

Figure 4

Reposition closet bowl towards the wall (Fig. 5) and its marked screw hole position. Insert flush pipe into the flush pipe connector. Place coupling nut and coupling washer on to the vertical end of the flush pipe. Insert flush pipe into the outlet valve and tighten the coupling nut with coupling washer in place.

Note: Flush pipe may need cutting down to suit arrangement.

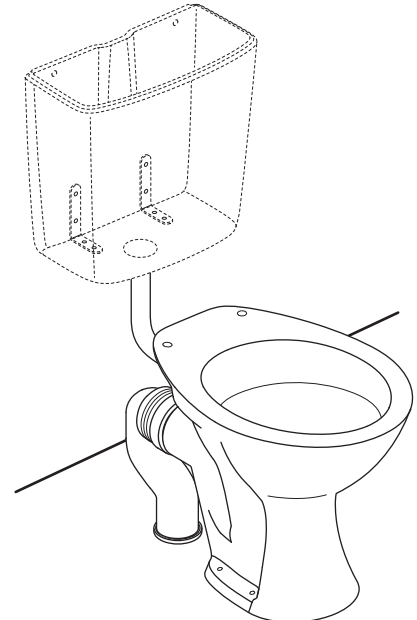

Figure 5

Screw closet bowl to floor with No. 12 RH woodscrews (not supplied).

Fit outlet valve push button assembly (where applicable) to cistern lid. Refer to separate push button instructions.

Connect closet bowl outlet to the soil system and connect inlet valve to water supply pipework and fill cistern.

Adjust fill valve to give correct water level as marked on cistern.

Flush the closet suite and check connections for leaks.

Close coupled

INSTALLATION

Diagrams below are pictorial only and outlines of items shown may not represent the actual pieces supplied.

Preparing cistern for fitting to closet bowl

Through bolting push sponge close coupled washer onto back nut, this ensures centralisation before offering up to closet. (Fig.6)

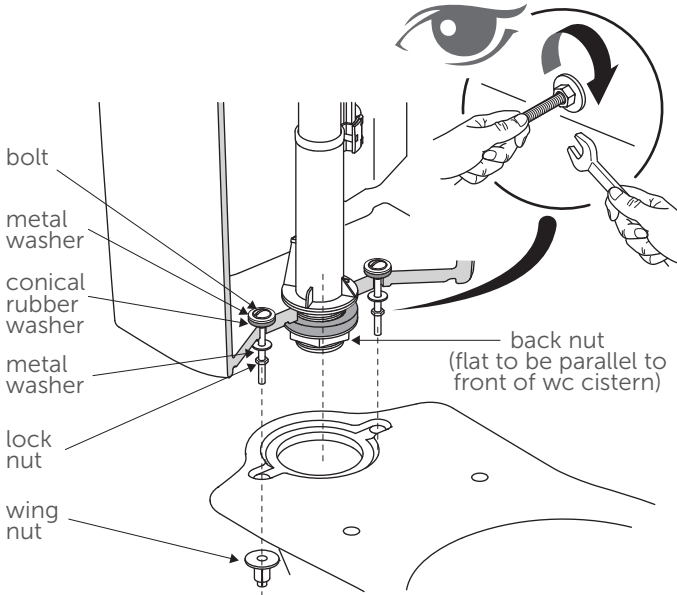

Figure 6

Close coupling plate

Locate rubber close couple washer in closet bowl recess (Fig.6.1)

Lower cistern onto closet bowl, and apply wing nuts to bolts and tighten by hand.

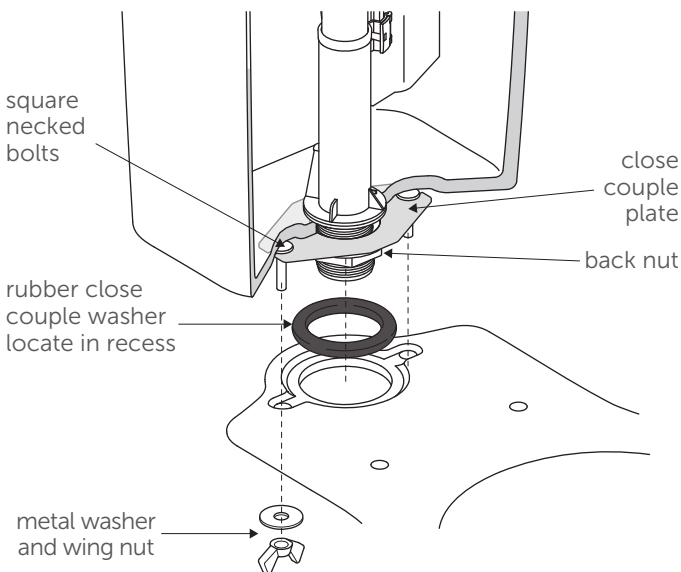

Figure 6.1

Locate closet suite to wall, fig. 7. With cistern lid removed mark cistern screw hole positions on wall. Remove closet suite, drill and plug wall.

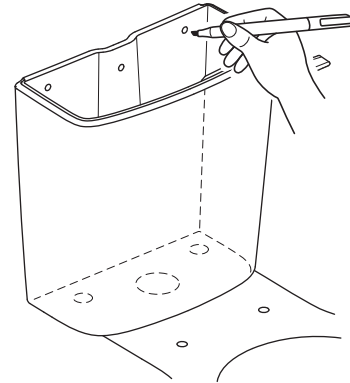

Figure 7

Reposition closet suite, figure 8, to wall, make connection to soil system and screw closet bowl to floor and cistern to wall, (screws not supplied).

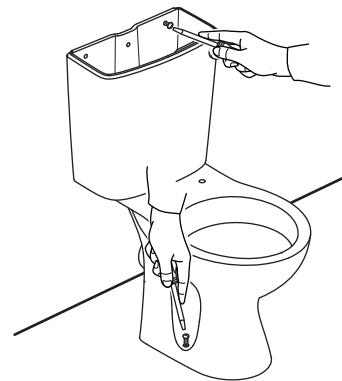

Figure 8

For closet suites supplied with their own individual floor fixation kit. Place the suite up to the wall in the required position and mark the outline of the closet bowl on the floor. Mark on the floor at both sides of the closet bowl, the position of the screw holes in the closet foot. Remove closet bowl, draw a line on the floor joining the marks which indicate the screw hole positions. Mark the position for the two fixing screws 40mm in from the line drawn around the closet, drill, plug and fit brackets to foot, fig. 9.

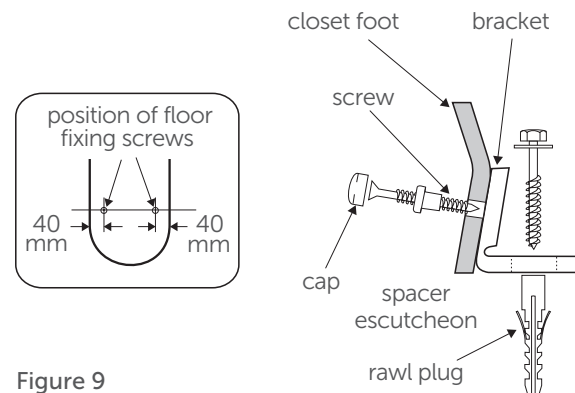

Figure 9

Connect float operated fill valve to water supply pipework, adjust fill valve to give correct water level as marked on cistern.

Fit outlet valve push button assembly (where applicable) to cistern lid. Refer to separate push button instructions.

Flush the closet suite and check connections for leaks.

Low flush volume option (where available)

BEFORE FITTING SYPHON

For cisterns indicated with optional 4/4.5L low flush volume, the syphon is pre-set to 6L.

To adjust flush volume setting, remove the slider plug (Fig. 10) and replace in the alternative hole position (Fig 10.1)

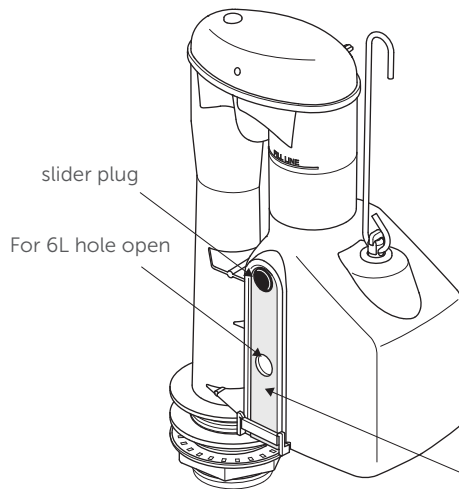

Figure 10

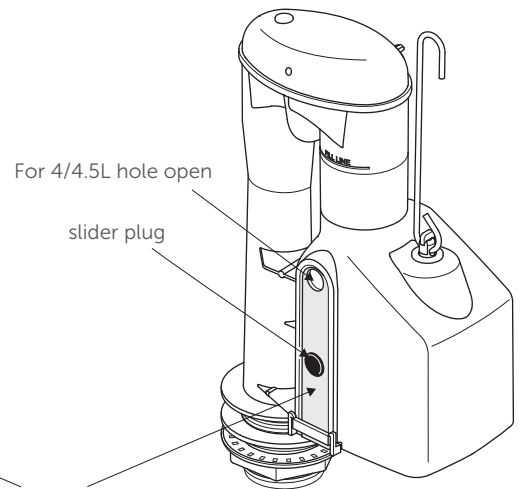

Figure 10.1

COVER FASTENER (WHERE USED)

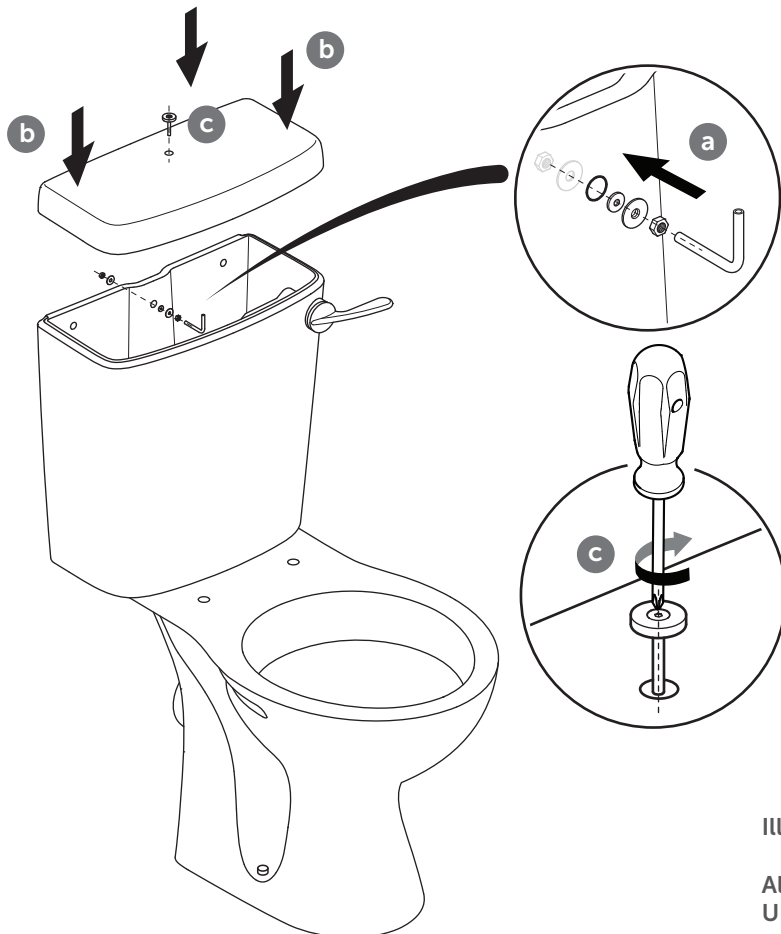

Illustration may not reflect item as supplied.

All cistern components must be installed in accordance with UK water regulations. If in doubt please consult a suitably qualified professional.

CUSTOMER CARE HELPLINE

01482 496318

FAX LINE 01482 499611

email: customer care@idealstandard.com

WW10002567

ver. 1.0/04.22