

# 1 A21504 Nabis Isos S/L Kitchen Mixer

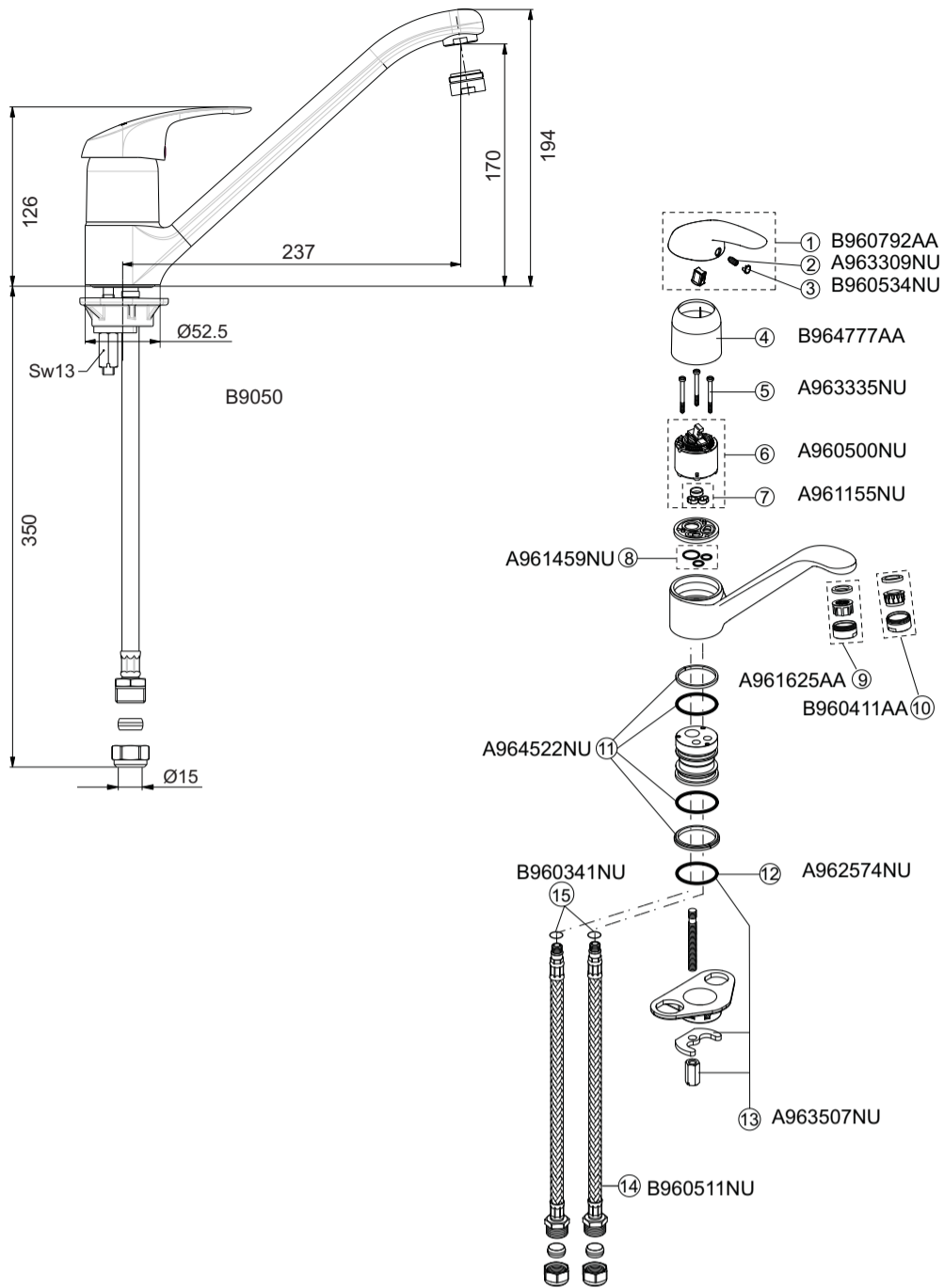

# 2 A21511 Nabis Vita S/L Kitchen Mixer

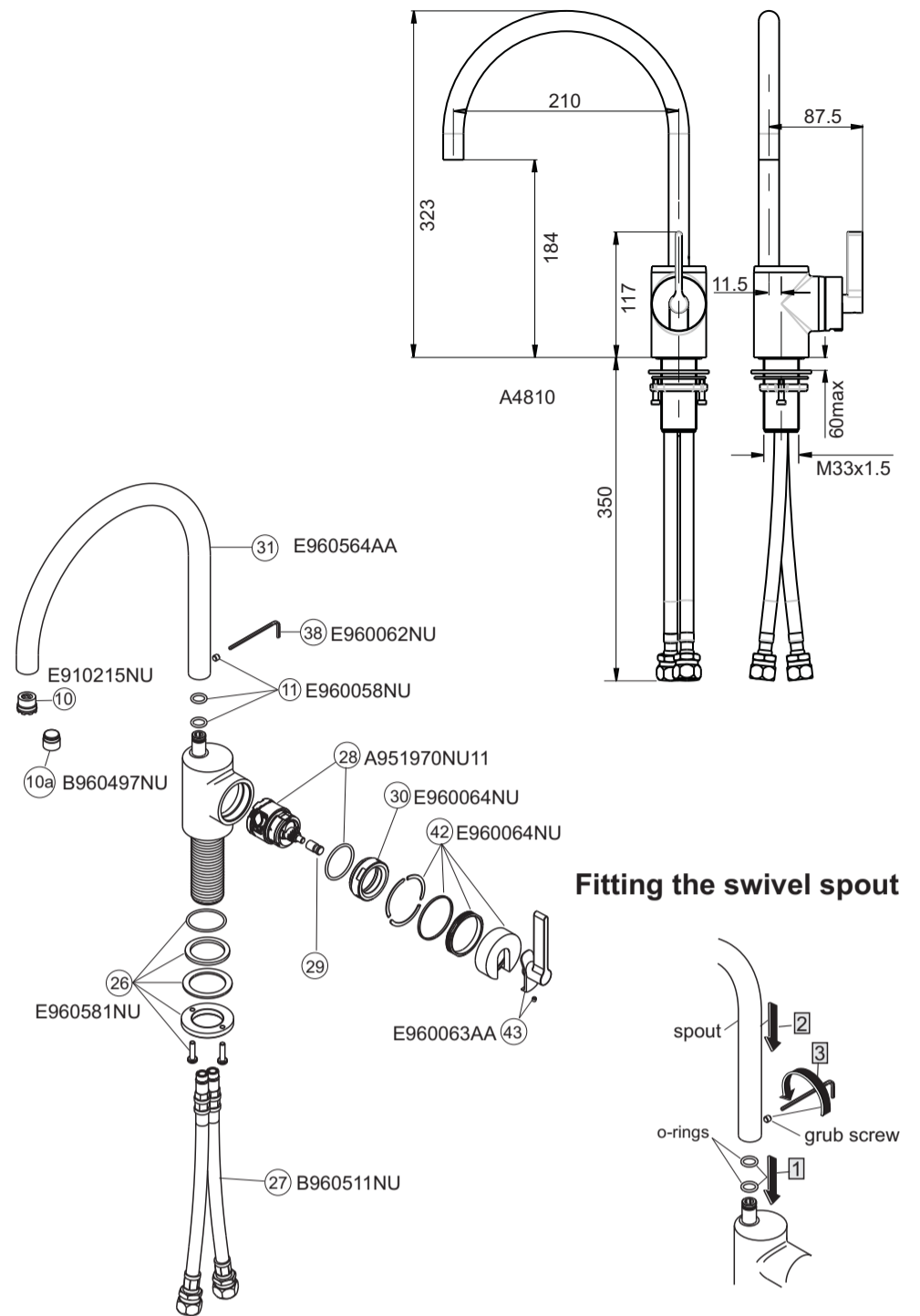

## 3 CONNECTIONS

The fittings covered by this instruction sheet are provided with flexible inlet tails for ease of installation which have 15mm compression connectors in the inlets for connection to conventional copper pipework

### WATER SUPPLIES

These mixers are designed to operate on supply pressures from 0.1 bar minimum to 5 bar maximum.

### CLEANING

When cleaning the fittings always use soap based cleaners. Never use abrasive or scouring powders and never use cleaners containing alcohol, ammonia, nitric acid, phosphoric acid or disinfectants.



## NABIS SINGLE LEVER KITCHEN MIXERS PART 2

### Mixers covered by this instruction sheet

- A21504 Nabis Isos S/L Kitchen Mixer Chrome
- A21511 Nabis Vita S/L Kitchen Mixer Chrome

**IMPORTANT NOTE**

Flush water through pipework to remove all debris etc. before connecting the fittings.

**The fittings covered by this installation and maintenance instruction should be installed in accordance with the water regulations published in 1999\*, therefore we strongly recommend that these fittings are installed by a professional installer**

If you experience any difficulties installing this product or require any additional information please contact the after sales team.

Phone: 0870 129 6085  
 FAX: 01482 499611  
 e-mail: UKcustcare@idealstandard.com

Wolseley UK, PO Box 21, Boroughbridge Road, Ripon, HG4 1SL.

\*A guide to the Water Supply (Water Fittings) Regulations 1999 and the Water Byelaws 2000, Scotland, is published by WRAS (Water Regulations Advisory Scheme) Fern Close, Pen-y-Fan Industrial Estate, Oakdale, Newport, NP11 3EH. ISBN 0-9539708-0-9

**INSTALLER: After installation please pass this instruction booklet to user**