

REVERSING THE CERAMIC DISC CARTRIDGE

The SE cartridge simply unscrews from the body using a 22 mm A/F deep socket or box spanner.

The stop plate may be repositioned to convert the rotation of the cartridge from clockwise to anticlockwise - or vice versa. To do this, prise off circlip with a small screwdriver, lift and rotate the stop plate by 90° and then refit the circlip. Figure 3

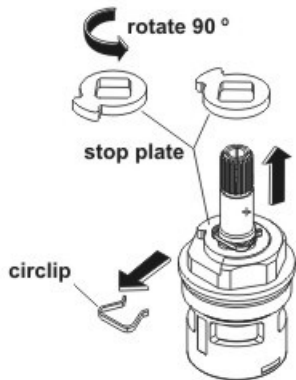

Figure 3

Quarter turn cartridge ½ SE & ¾ SE