

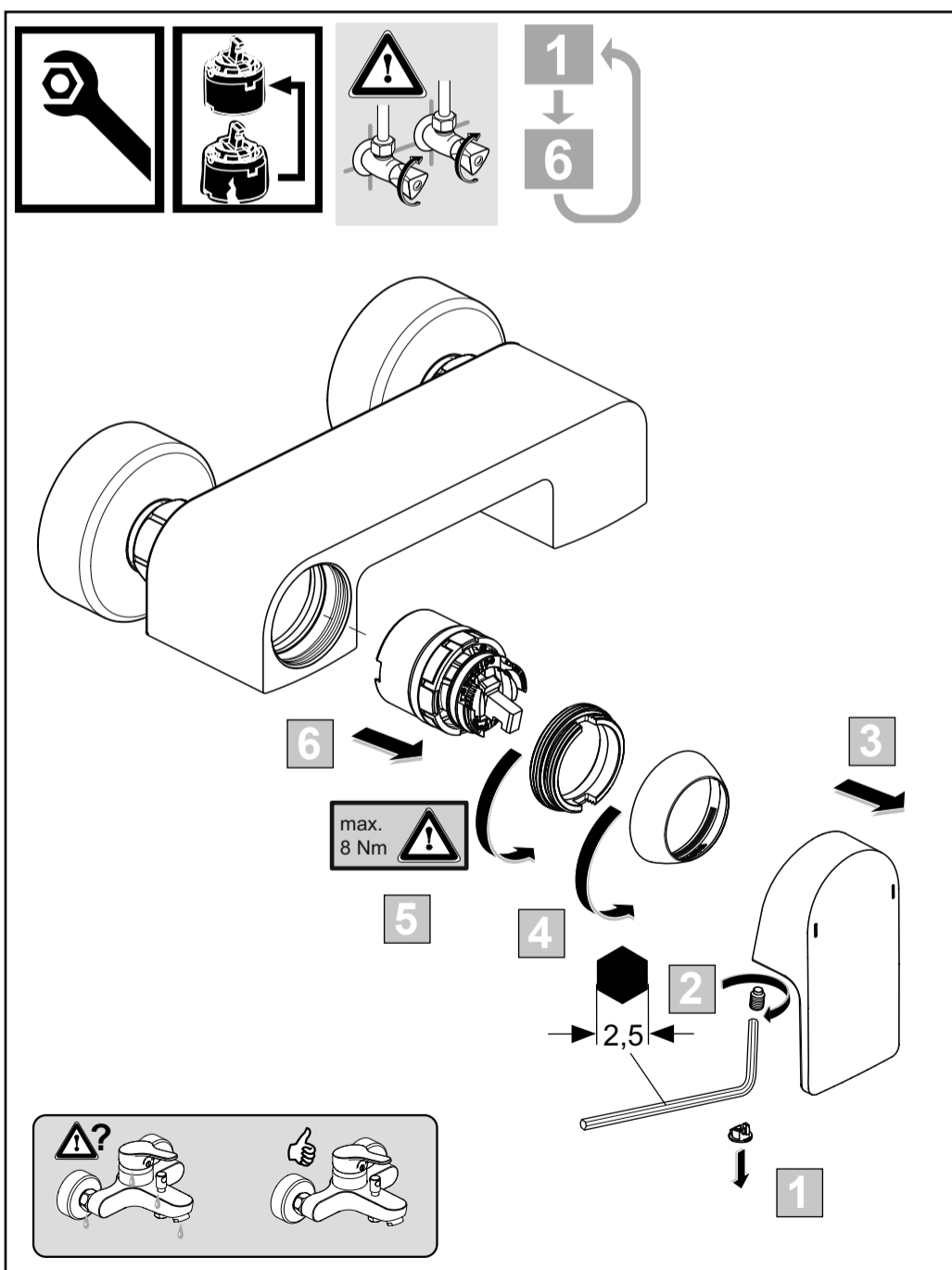

Ordering spares / Ersatzteil - Regelung / Pièces de rechange / Parti di ricambio / Lista de recambios / Onderdelen bestellen (NL/B) / Κωδικοί Ανταλλακτικών / Bestilling af reservedele / Beställning av reservdelar / Bestilling av reservedeler / Резервни части / Запчасти / Części zapasowe / Piese de schimb / Rendelhető alkatrészek / Запасні частини / Резервни делови / Резервни делови / Atsarginių dalių / Tellitavad varuosad / Rezerves daļas / Náhradní díly / Náhradné diely / Yedek parça siparişi / Nadomestni deli

XX = AA, AD, .....

- 1 - B 961648 XX
- 3 - B 960473 XX
- 4 - B 961373 XX
- 5 - B 961374 NU
- 6 - A 861181 NU
- 7 - B 961491 NU
- 11 - B 960562 XX
- 12 - A 961640 NU
- 13 - B 964675 XX
- 14 - B 961346 NU
- 15 - A 960537 XX
- 16 - B 961042 NU
- 22 - B 960925 XX

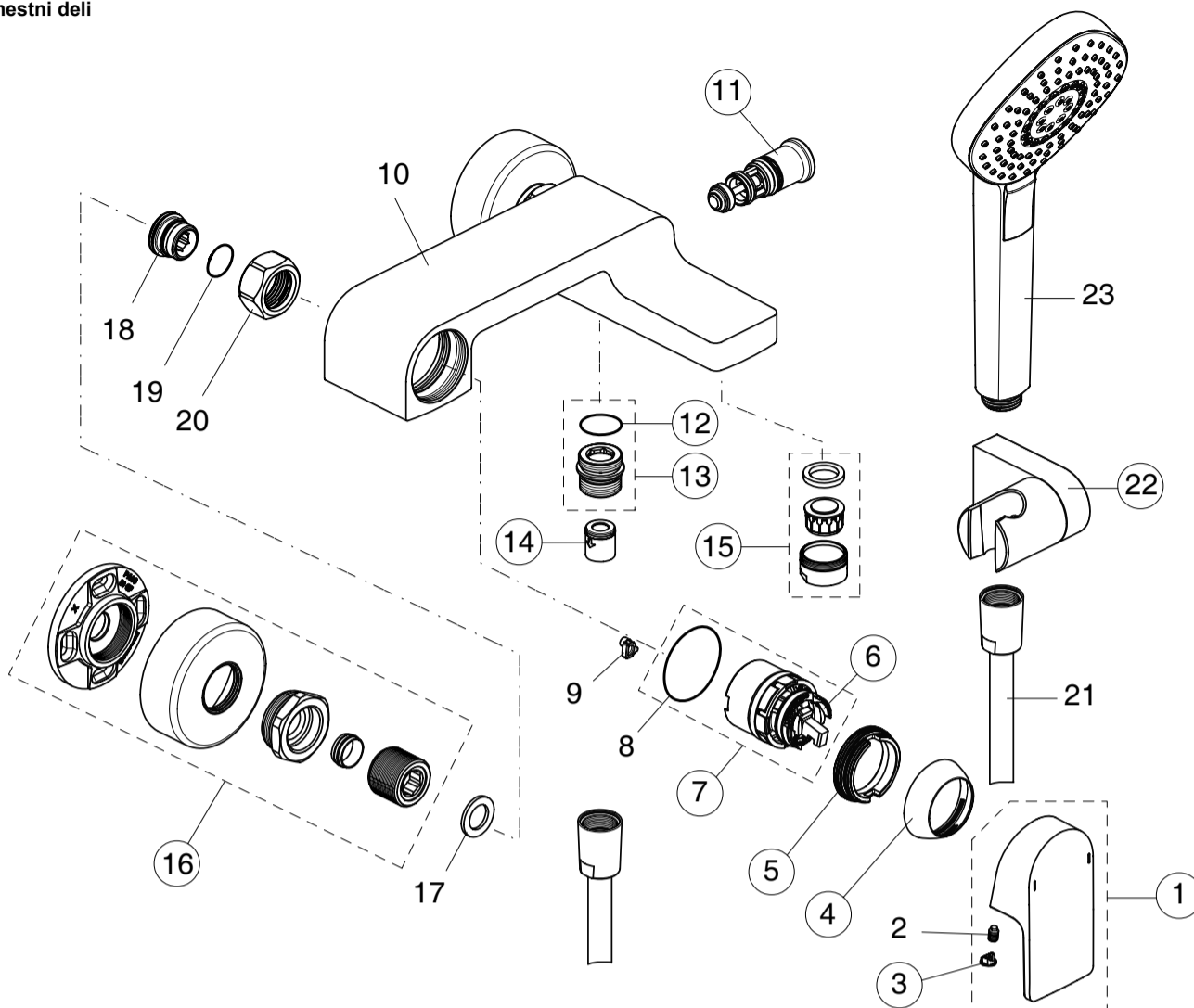

sottini

CENO

09.2019 / B665993

B C431 ..

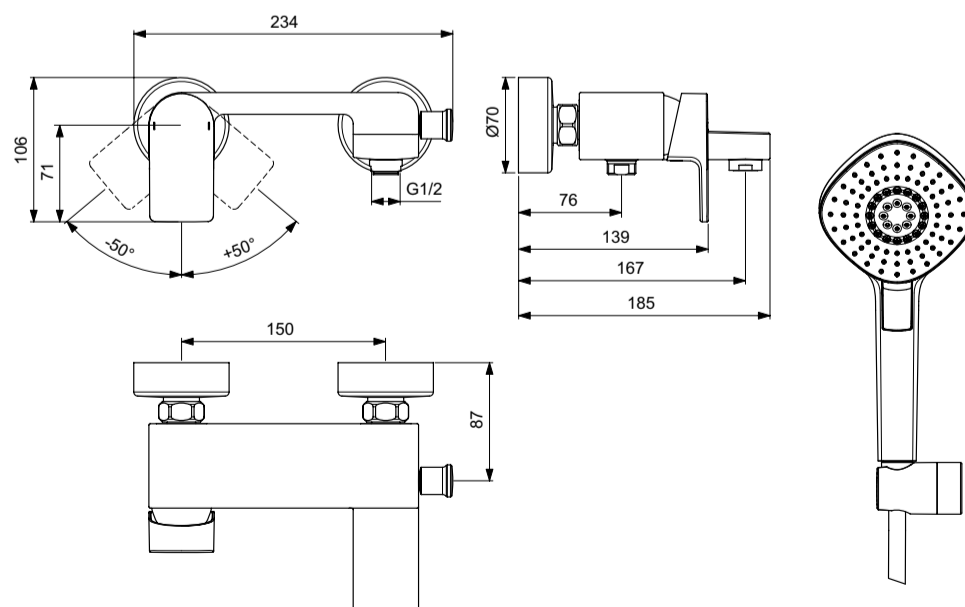

Ideal Standard International NV  
Corporate Village – Gent Building  
Da Vincilaan 2  
1935 Zaventem  
Belgium  
<http://www.idealstandardinternational.com>

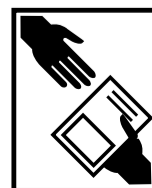

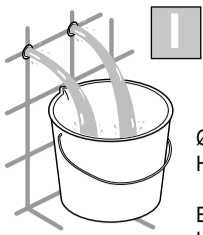

Ø15mm copper supply pipes should be run within the wall cavity. Hot supply pipe should be on the left hand side and the cold on the right.

Ensure that the hot and cold pipes are positioned 150mm apart and are level. Use the template provided to obtain the correct spacing.

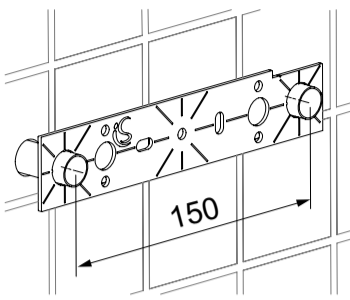

1

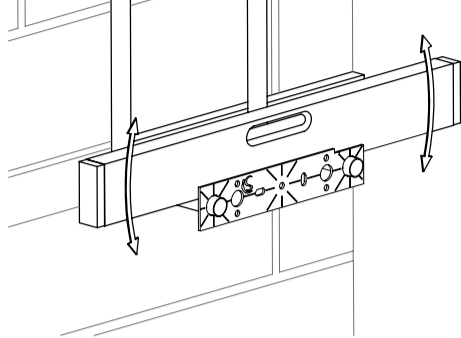

We recommend leaving 50mm of pipe protruding at this stage.

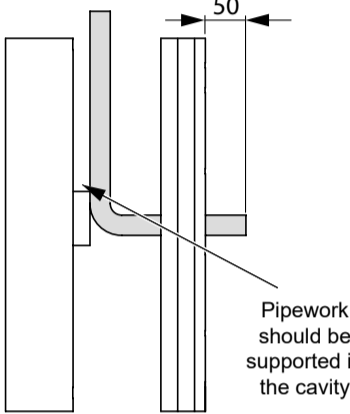

Pipework should be supported in the cavity

2

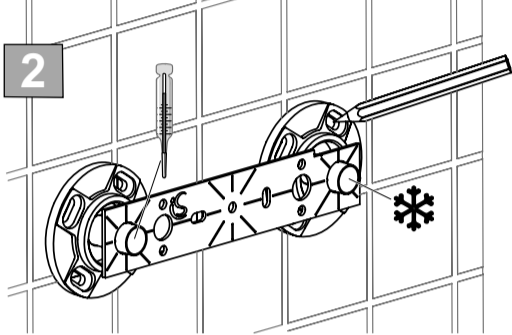

Place the brackets over the exposed pipes and use the template provided to position them 150mm apart. Mark the hole positions for the fixings onto the mounting surface. Ensure that the positions of the holes will not result in damage to the pipework inside the wall cavity during drilling.

3

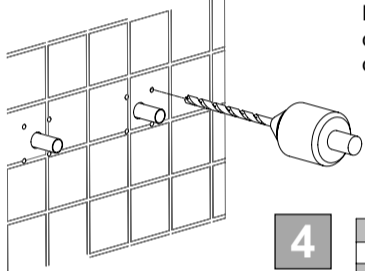

Drill holes appropriate for your choice of fixings into the wall.

We recommend a minimum of two fixings per bracket diametrically opposed.

Drill carefully to avoid damaging concealed pipework.

4

The pipes should be trimmed level to the wall bracket. If using a pipe cutter it will be necessary to mark the pipes and then remove the bracket before trimming to its correct length

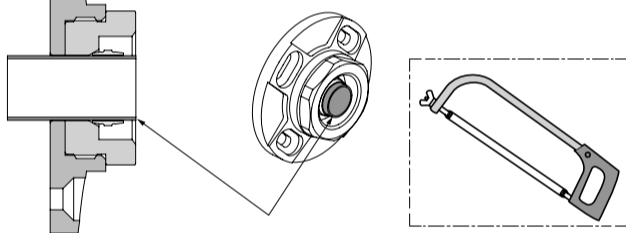

5

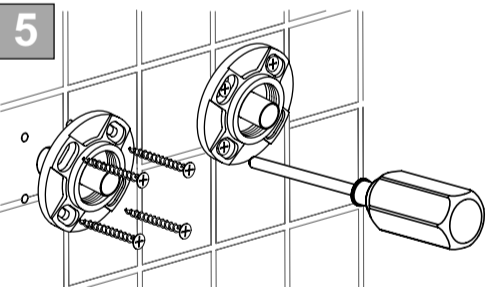

6

Screw the brass adaptors over the pipes into the plastic brackets. 36mm A/F Spanner flats are provided, hand tightness is adequate.

7

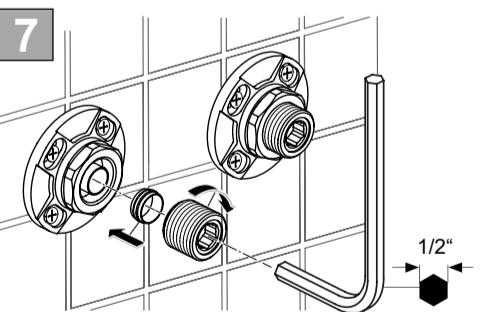

Fit the olives to the pipes prior to screwing the two 3/4" connectors into the wall mount plate using a 1/2" allen key. The connectors will have to be securely screwed in to form the necessary compression joint between the olive, wall plate and connector. Retain the brass adaptors with a spanner when making the compression joints.

8

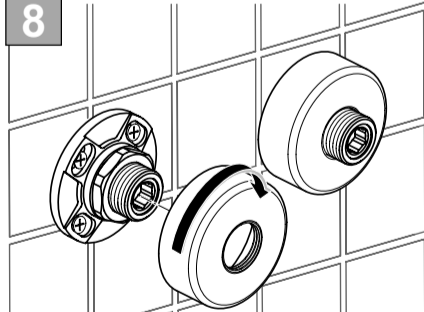

When the sealant has set, fit the covers by screwing them onto the adaptors until they are flush with the wall. The covers only need to be hand tight.

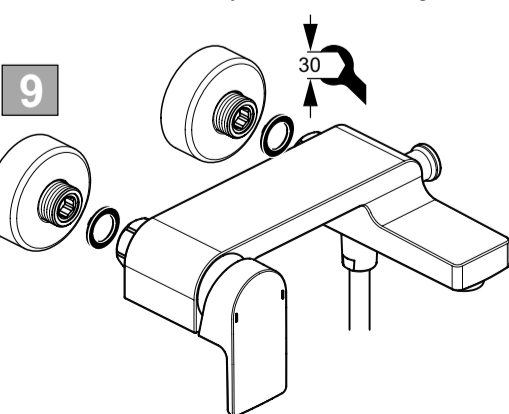

9

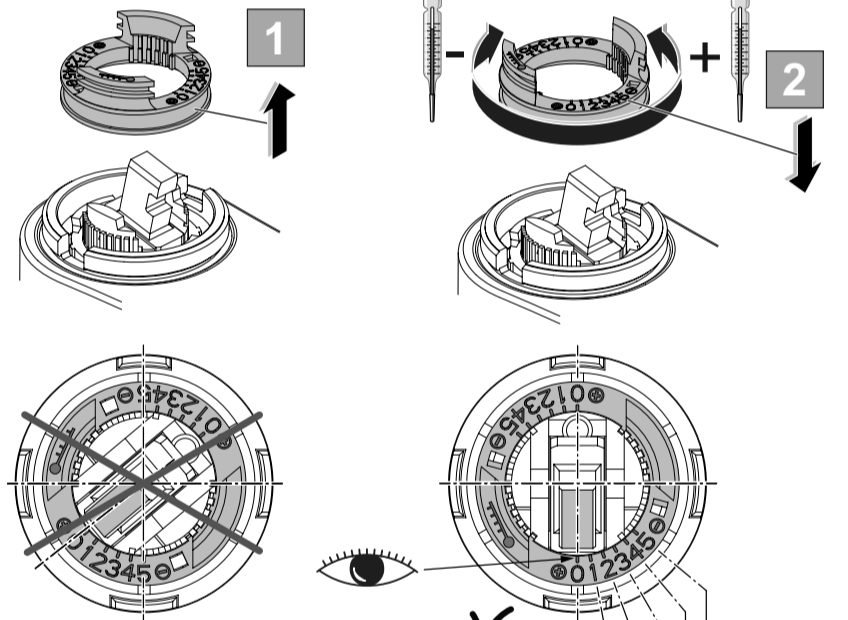
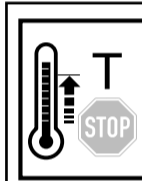
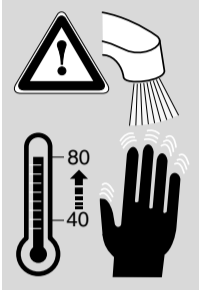
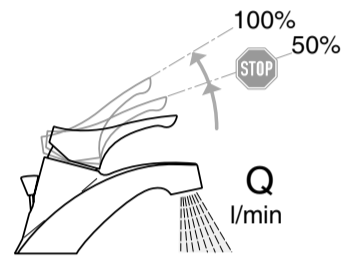
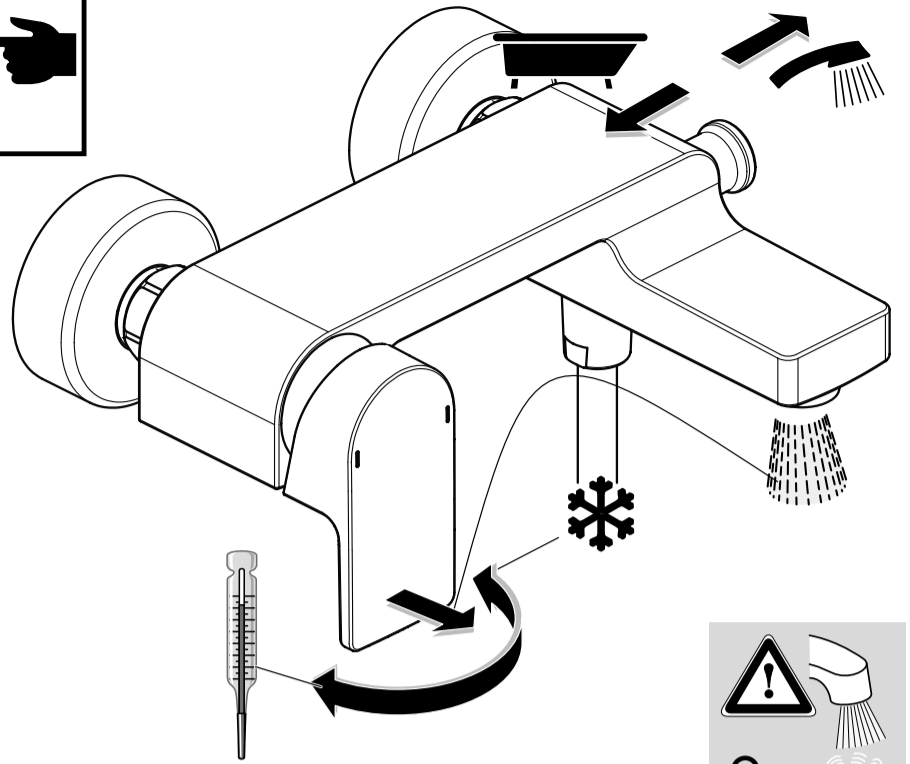
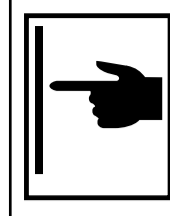
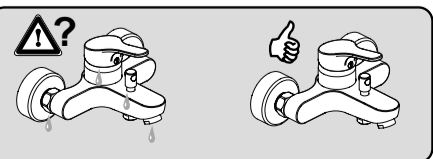

P	°C	°C	0	1	2	3	4	5
			50	49	44	40	35	33
0,3 MPa 3 bar	65°C	15°C	65	63	57	50	44	40
	85°C	15°C	85	83	74	64	56	50

P bar	0,5	MAX. 10	5	1	Q (3 bar)
T °C	MAX. 80	65	40	I/min	21
					8