

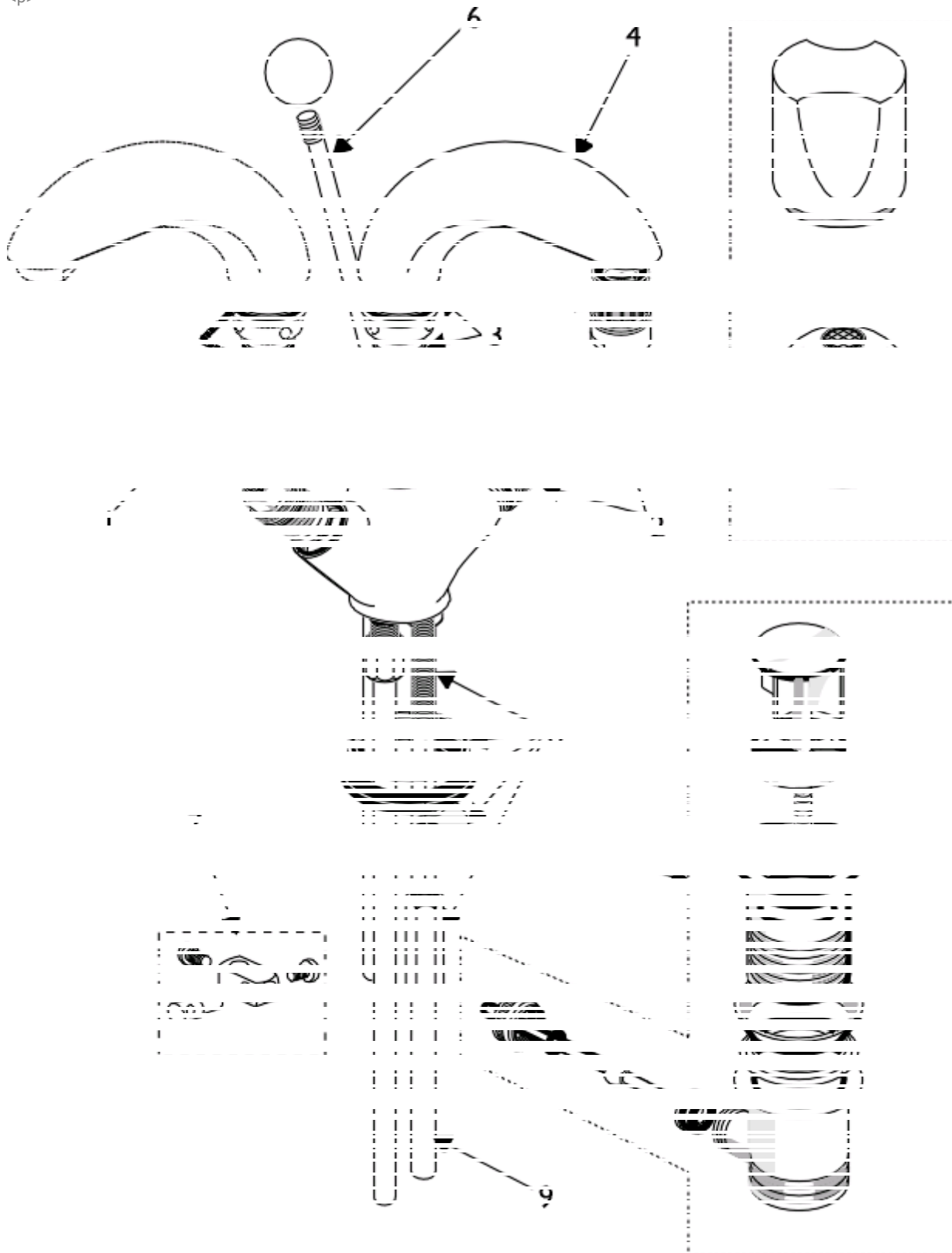

<p>



8a →  ← **New alternative deck seal introduced Sep 2006**

Ref.	Description	Part No.
1	Handle Carrier	A922539
2a	1/2 IS rubber valve internal headwork inc screw	A951130NU11
2b	Valve screw	E918322NU
3	Swivel spout repair kit	E960375NU
3c	SACHET OF GREASE	E050012NU
4	Spout complete	E960137AA
5	Flow straightener	A961625--
6a	Pop-up knob (was E908771--)	A909938AA11
6c	Pop-up rod Chrome	B950749AA
7	Pop-up rod fixing clip	A963404NU
8	Fixing kit	E950607NU
8a	CENTRAL SEALING GASKET AD=42.5	A961302NU
9	Pair of M12 inlet tails complete with o-rings	E960517NU
10	Pop-up waste complete	E950612--

NB -- colour/finish options

Chrome = AA

Gold = AZ

White = AC